

Označení dílů

M – fotoleptané kovové díly
D - obtisky
? - volba

Parts labelling

M – photoetched parts
D - decals
? - option

Zbarvení

Celé vozidlo bylo v pouštní žluté barvě

Camouflage

All vehicle was in desert yellow

Návod ke stavbě

Při stavbě postupujte podle instruktžních obrázků.

Instructions

Follow the instruction drawings the assembly.

Upozornění: Během opracování může vznikat prach, který může dráždit dýchací cesty. Používejte ochranu očí při odšťihování kovových dílů.

Notice: Machining can produce dust which can be irritating to the respiratory tract. Metal parts should be cut off using protection eyesight.

Kupujte přímo na www.plusmodel.cz
Buy directly from www.plusmodel.cz

Plus Model s.r.o
Jižní 56, 370 10 České Budějovice
Czech Republic
<http://www.plusmodel.cz>
e-mail: plusmodel@plusmodel.cz

321

plusmodel

1/35

MORRIS COMMERCIAL CDSW 30-CWT Artillery tractor

Historie

Tahač polních a protiletadlových děl Morris – Commercial CDSW byl jednou z variant tohoto vozidla, které vzniklo zástavbou šestiválcového motoru, místo čtyřválcového, do vozidel CD 6x4, vyráběných od roku 1935. Morris CDSW se používal také jako lehké odtažové a vyprošťovací vozidlo. Všechny verze měli naviják.

Mnoho těchto vozidel bylo ztraceno ve francouzské kampani a byly používány také německou armádou.

Technická data

Motor – šestiválcový, kapalinou chlazený zážehový
objem 3485 ccm
max výkon 45 kW

Převodovka – 5 stupňů vpřed a 1 vzad

Hydraulické brzdy

Naviják 40 kN (4 tuny)

Celková hmotnost 3327 kg

History

Morris – Commercial CDSW artillery tractor, one of many versions of this lorry, was based on a CD 6x4 type but with a six-cylinder engine instead of a four-cylinder one.

The production started in 1935. Morris CDSW was used as light breakdown

All versions were fitted with a winch.

Many of these cars were lost during the French Campaign and some of them were later used by Germans.

Technical data

Engine – six-cylinder, liquid-cooled, spark ignition
capacity 3 485 cc
max. output 45 kW

Gearbox – 5-speed gear with reverse

Hydraulic brakes

Winch 40 kN (4 tons)

Gross weight 3 327 kg

1

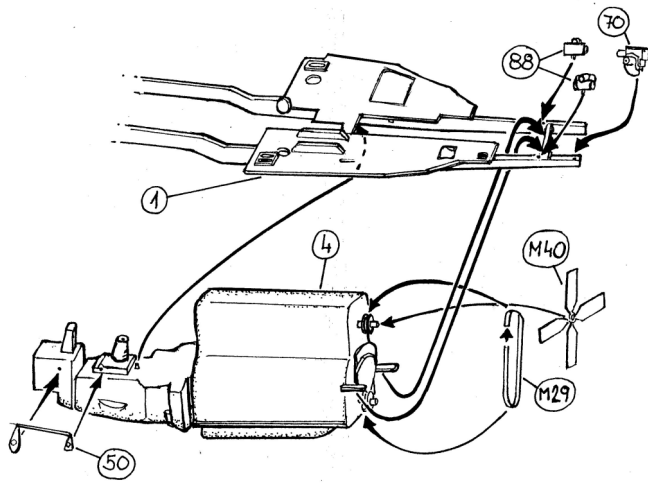

2

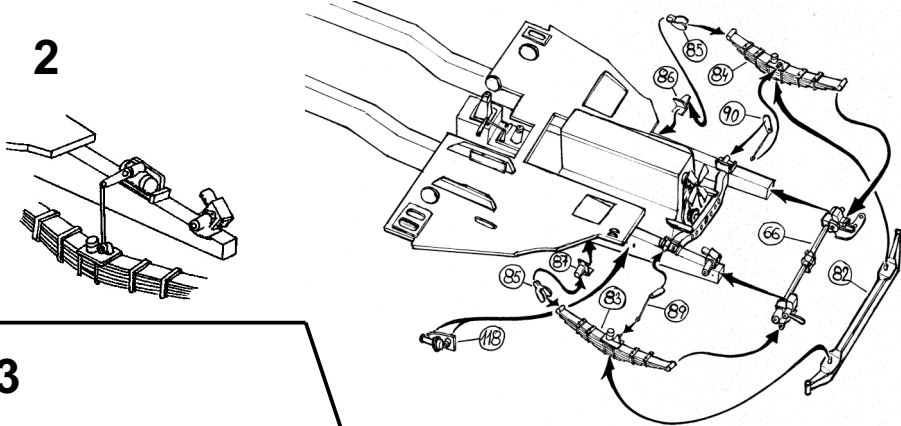

3

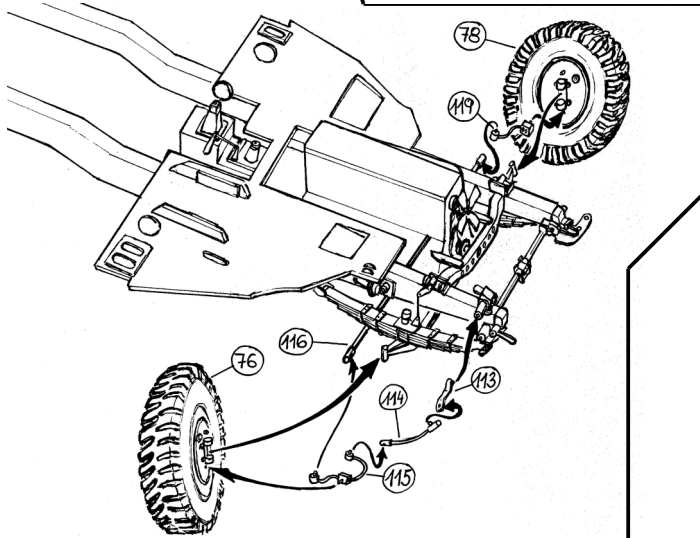

4

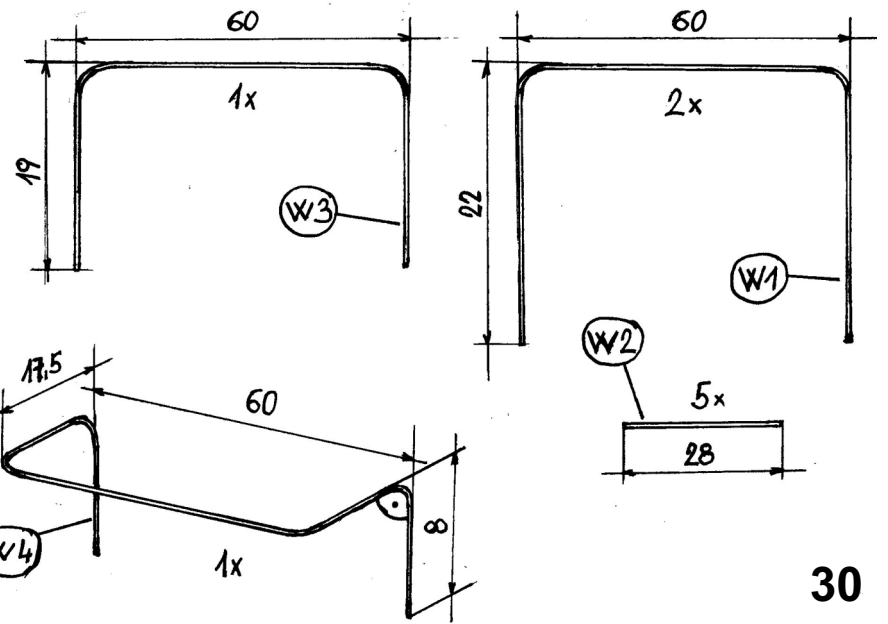
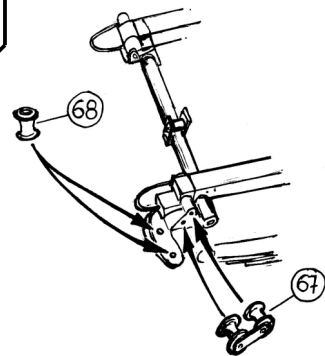

30

MAKE FROM WIRE 0,8 mm

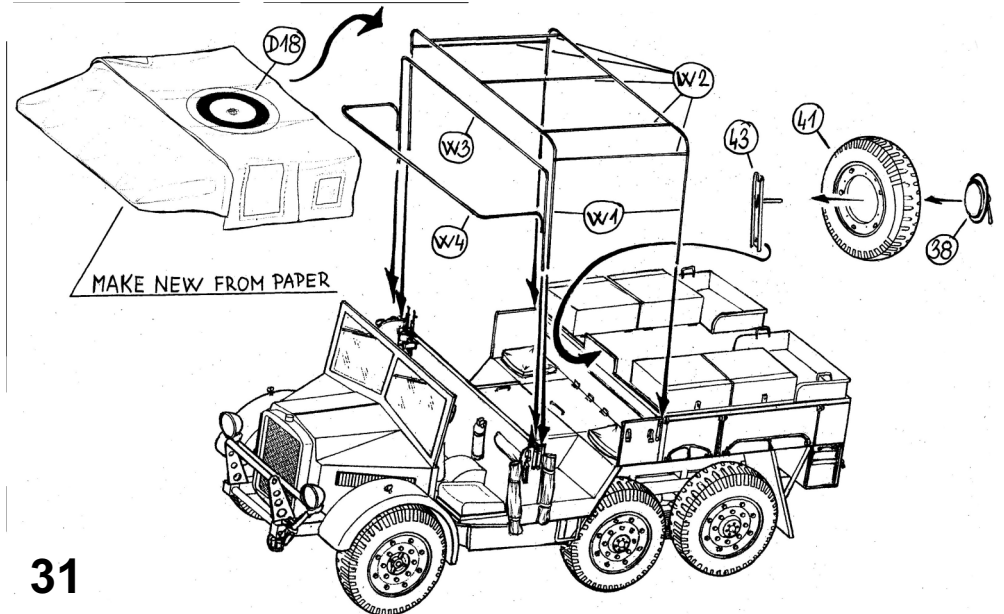

31

28

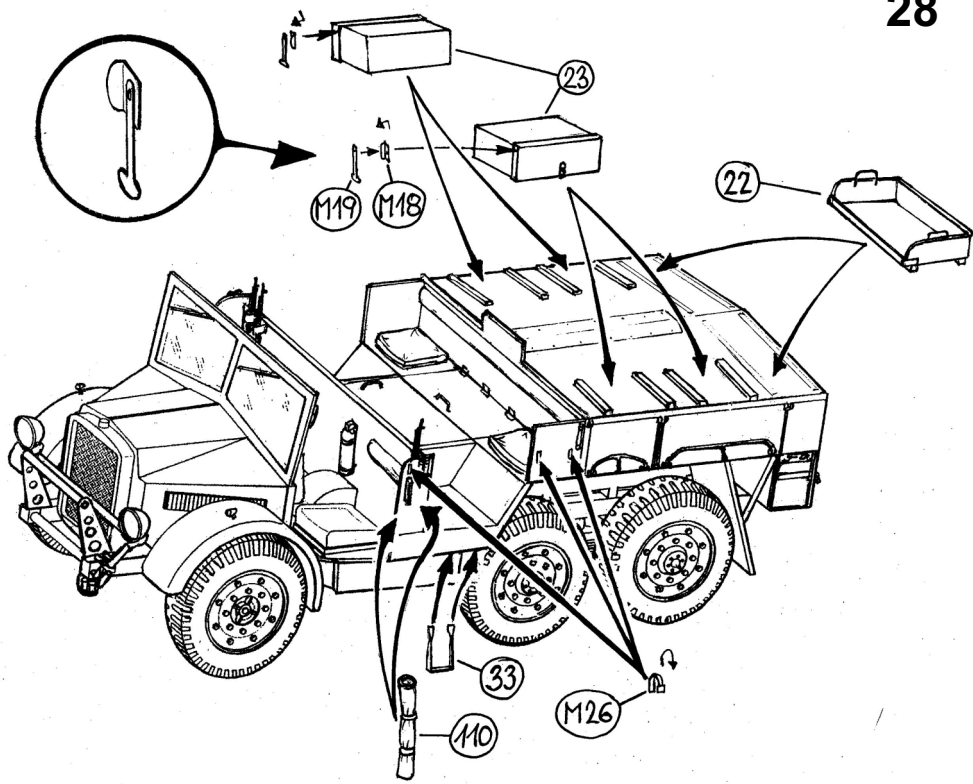

5

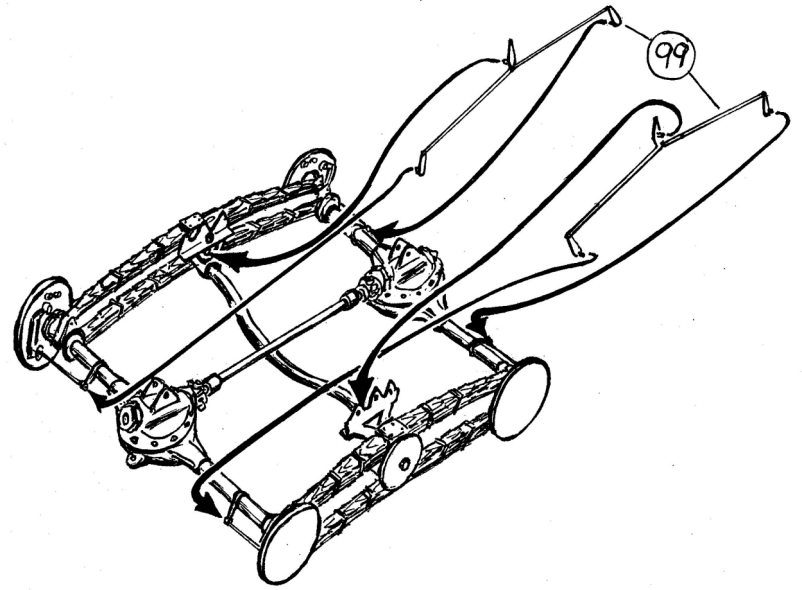

6

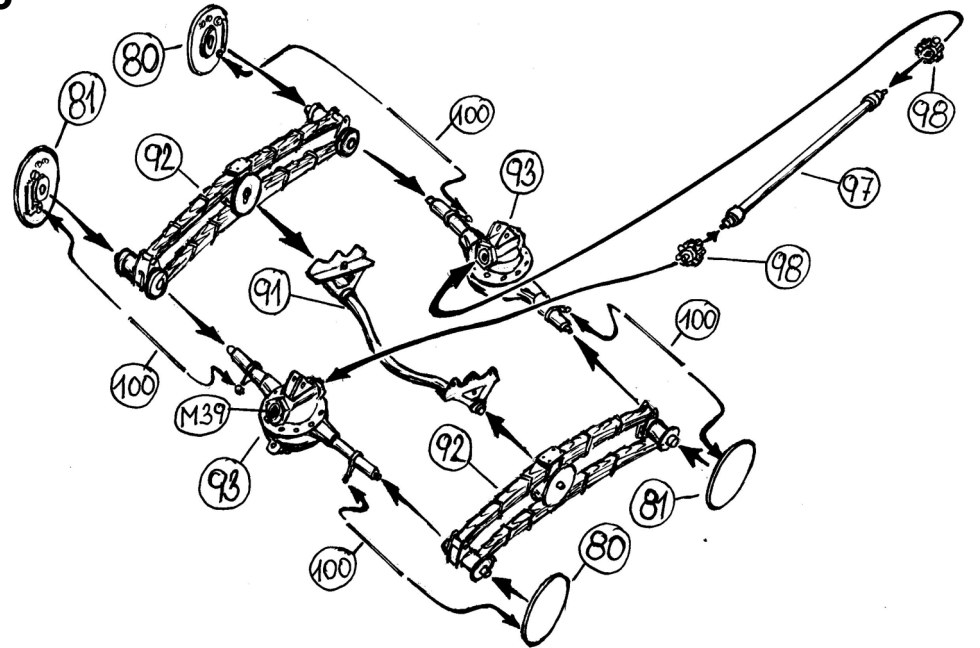

29

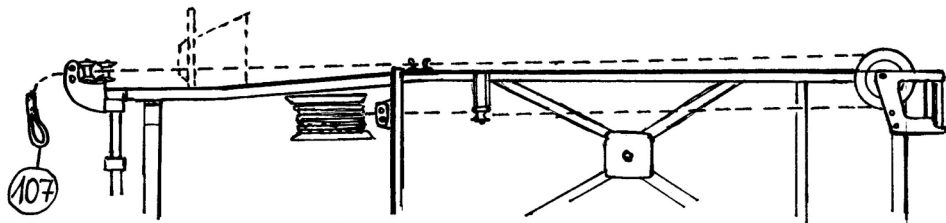

7

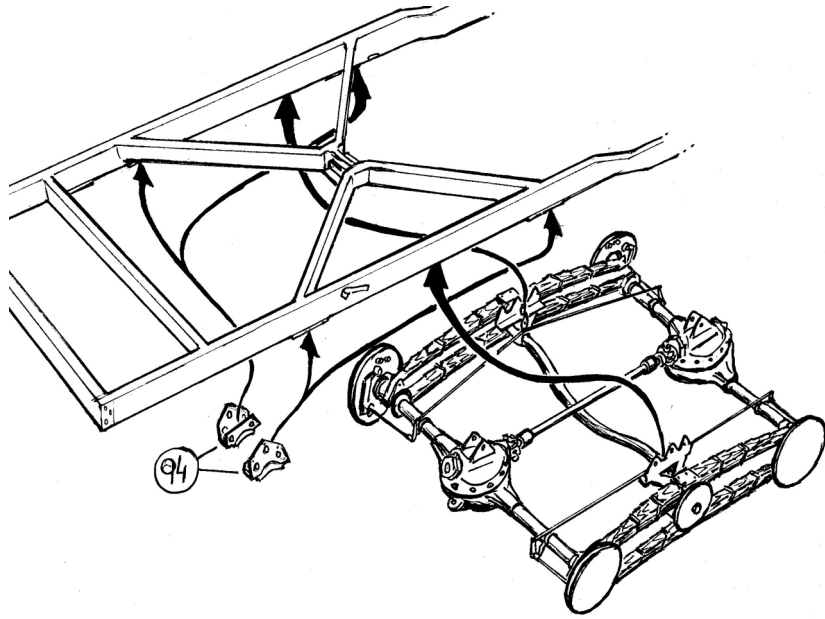

8

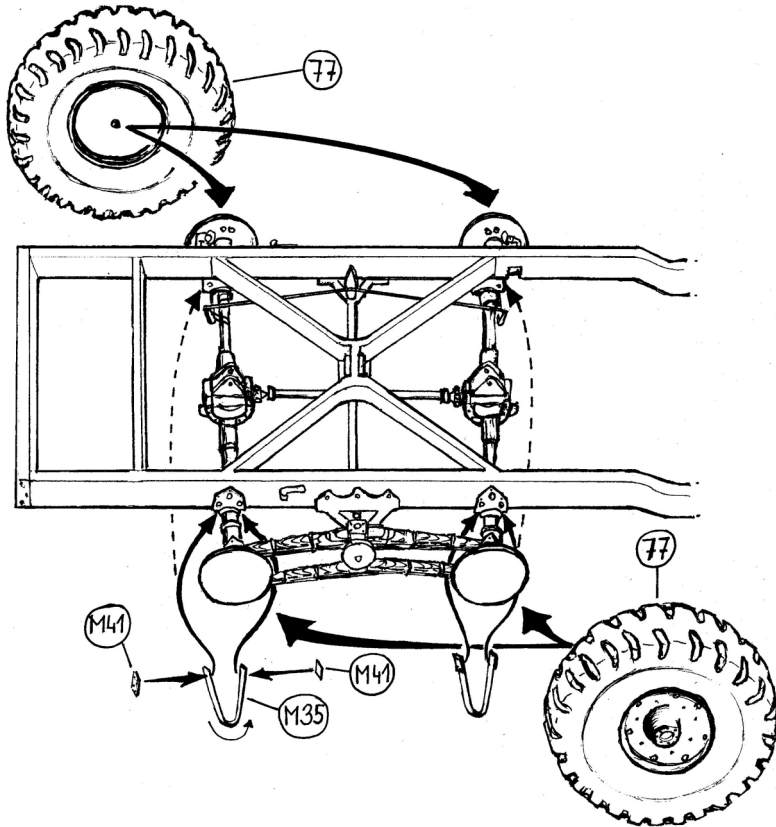

26

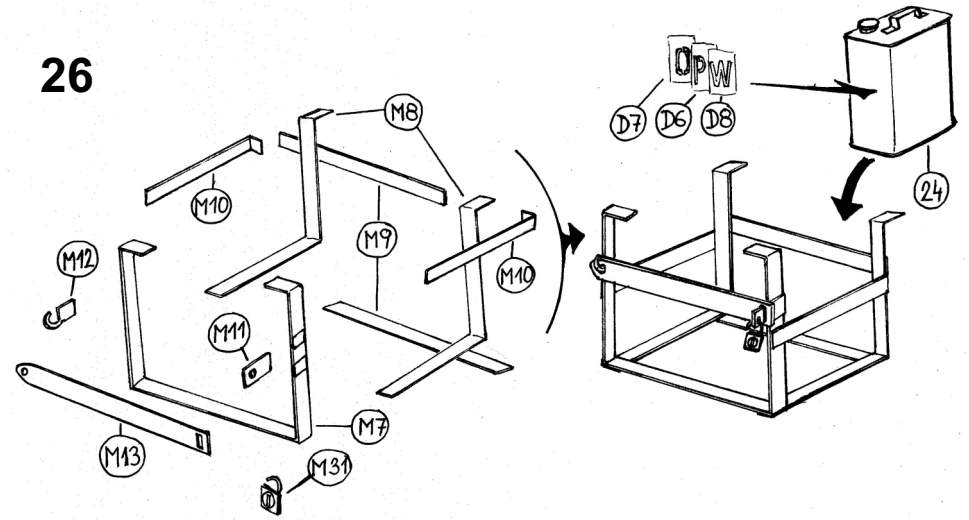

27

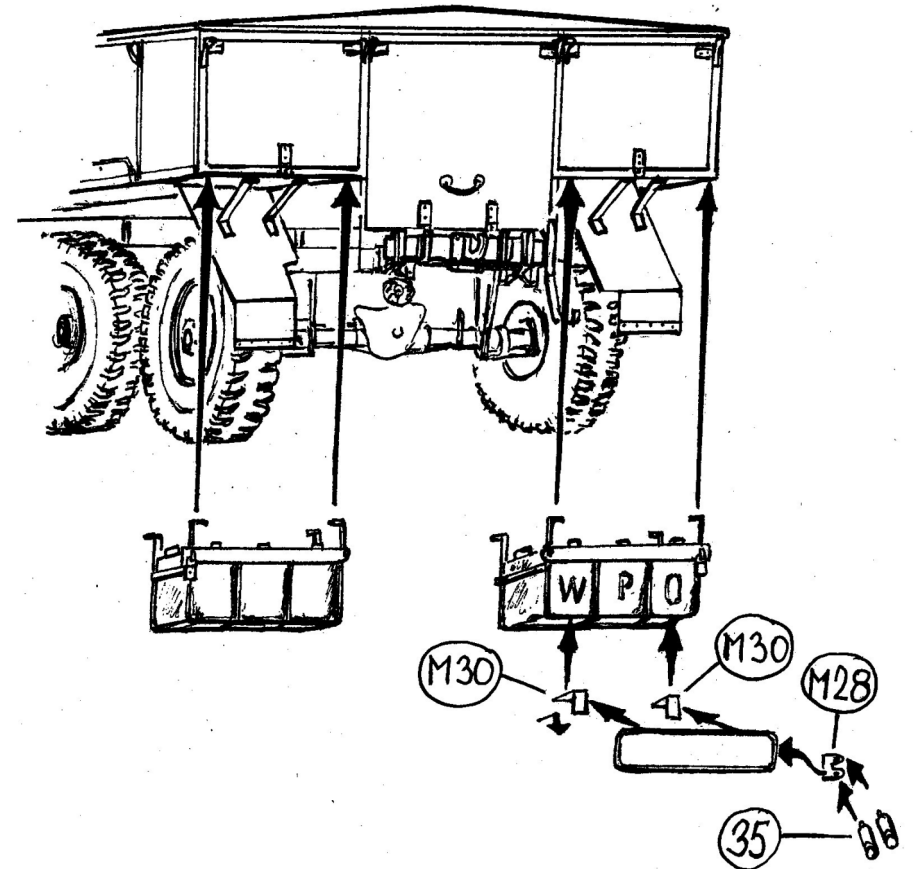

24

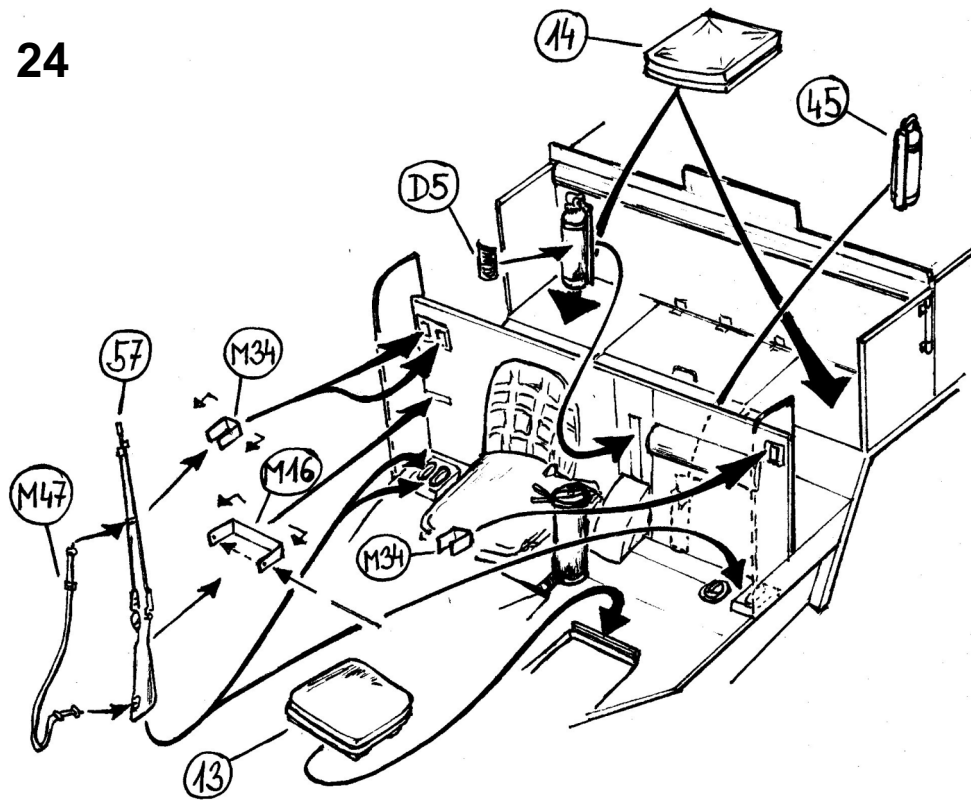

25

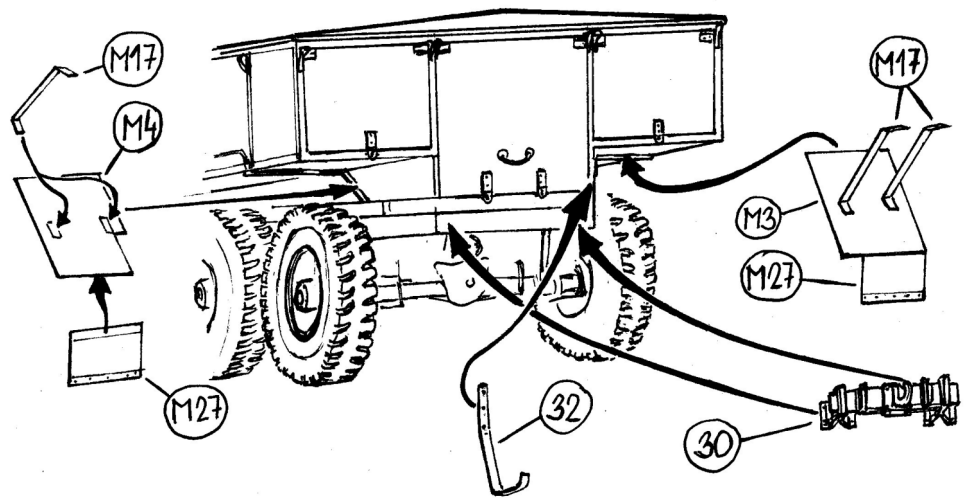

10

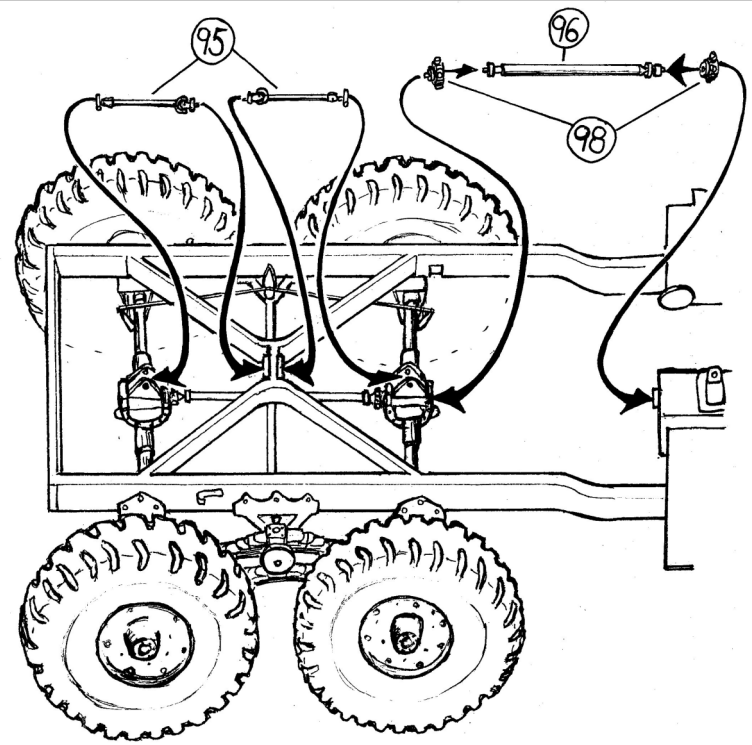

11

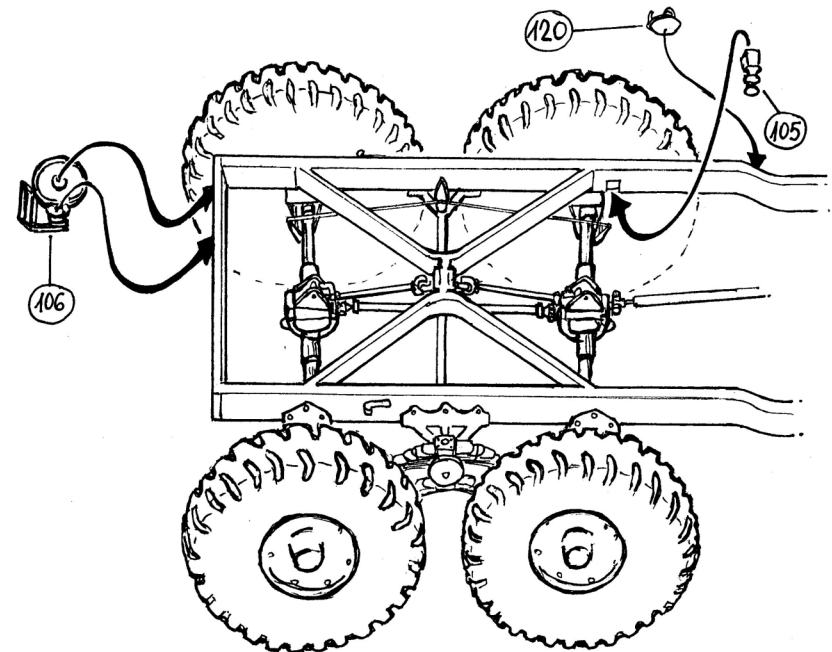

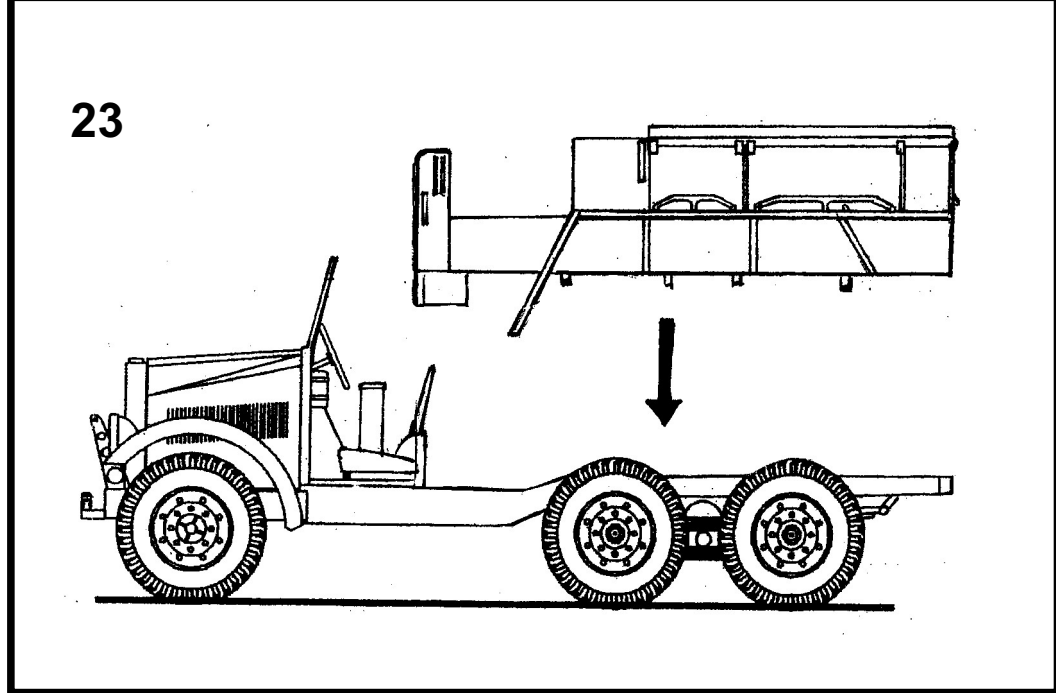
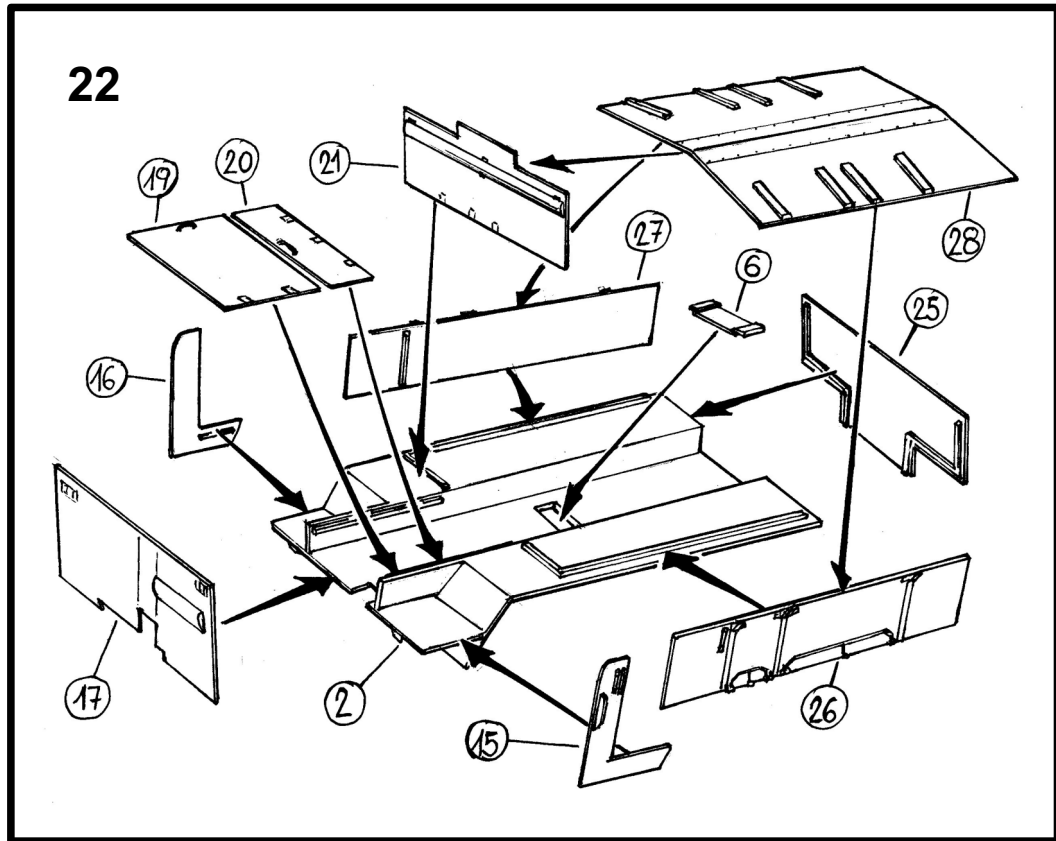
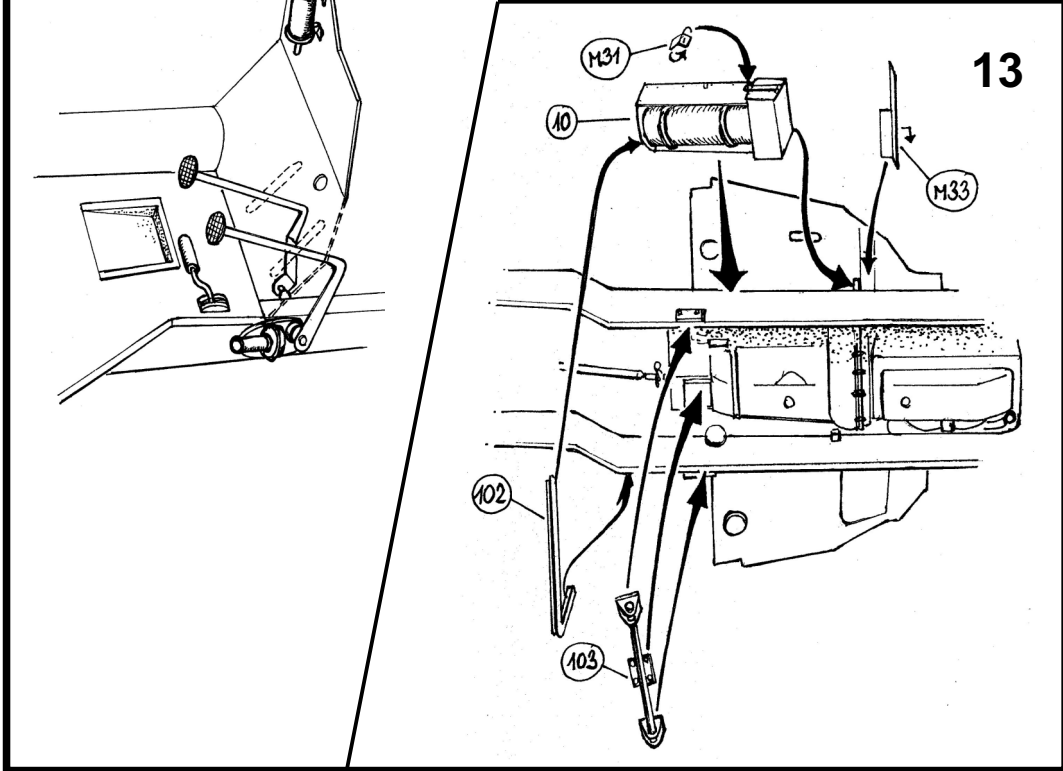
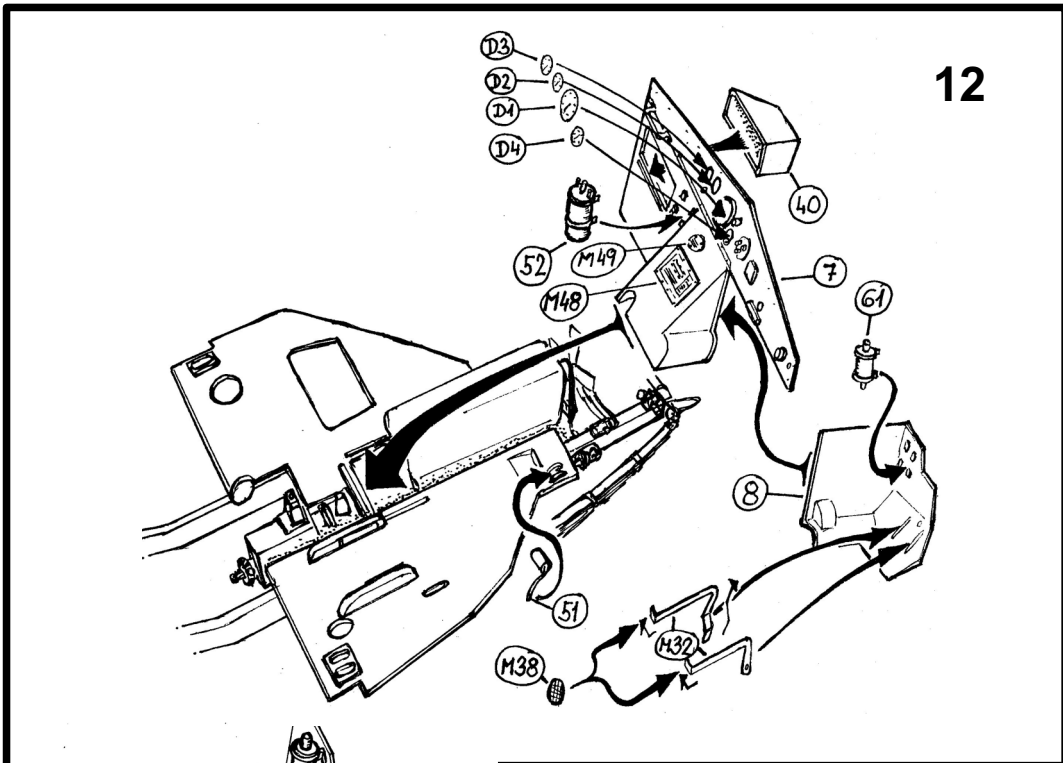

20

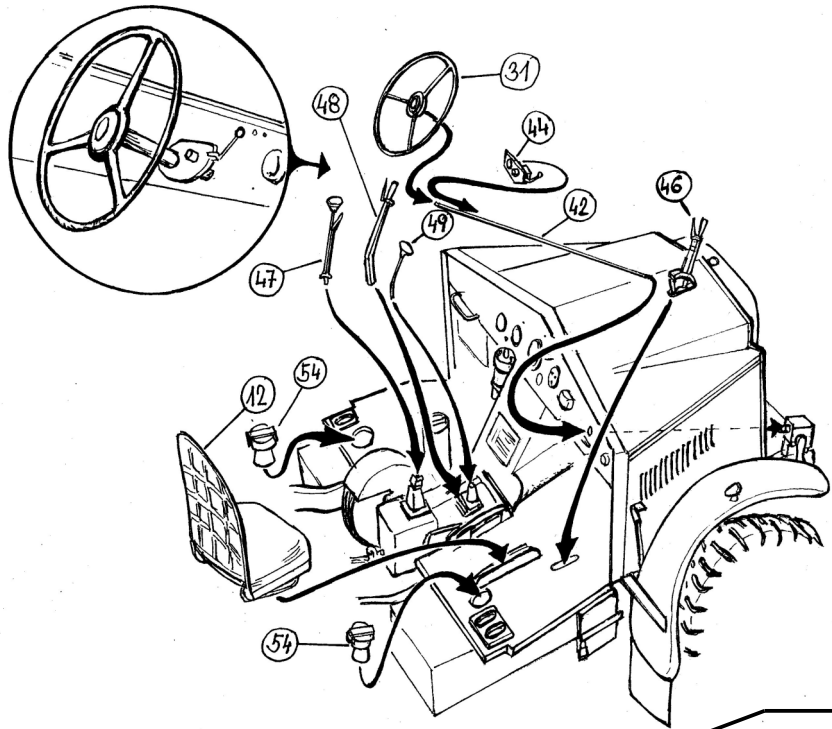

14

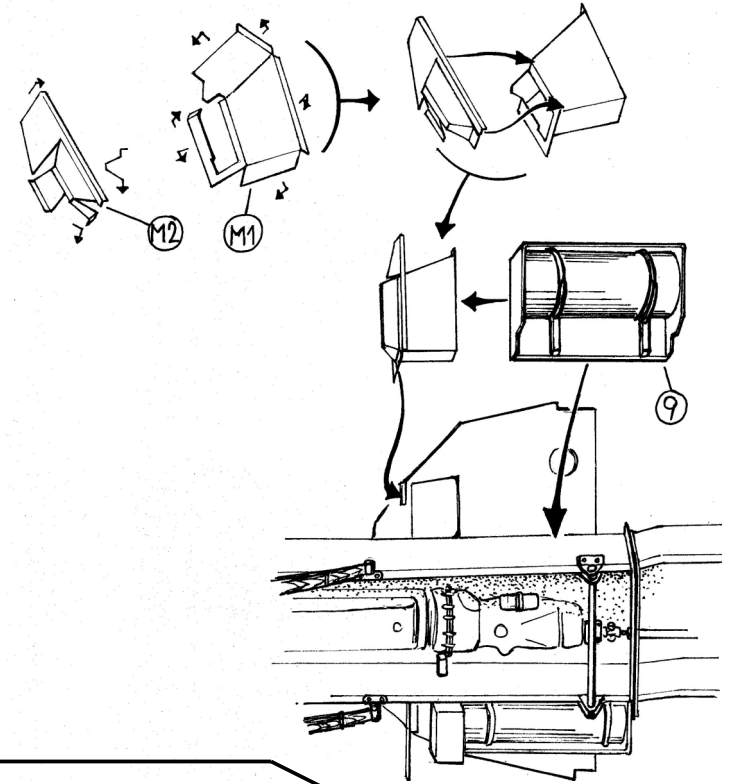

21

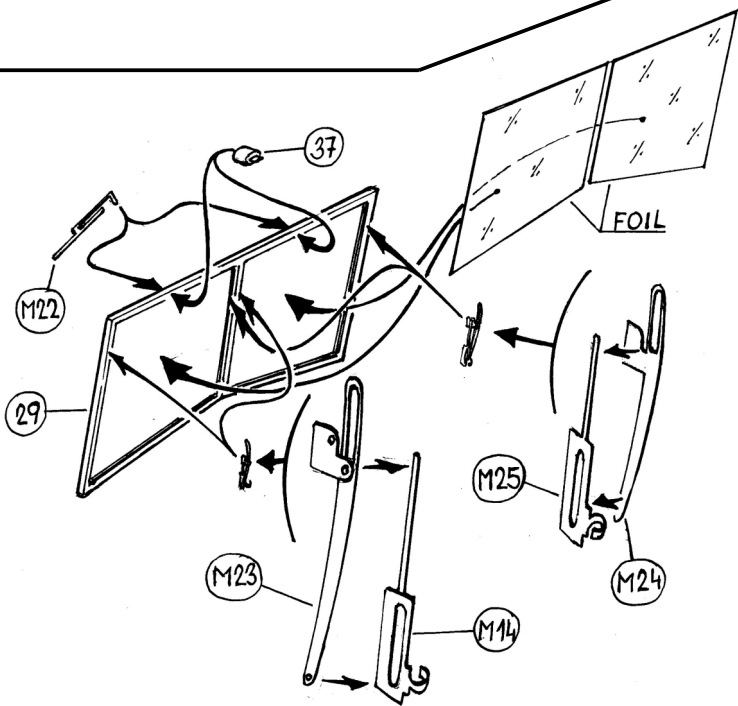

15

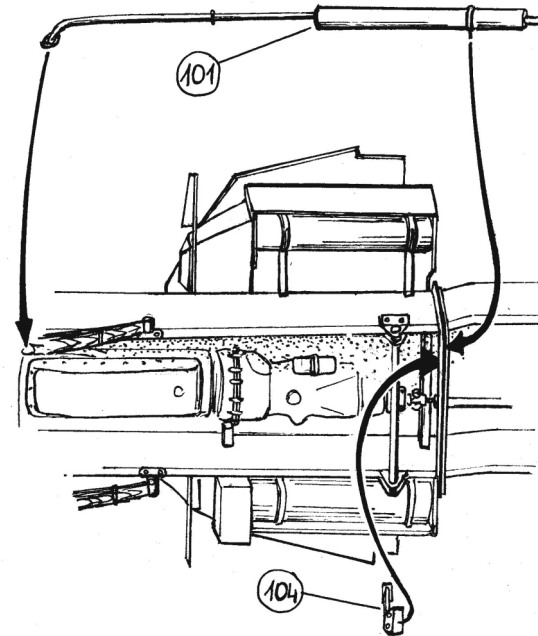

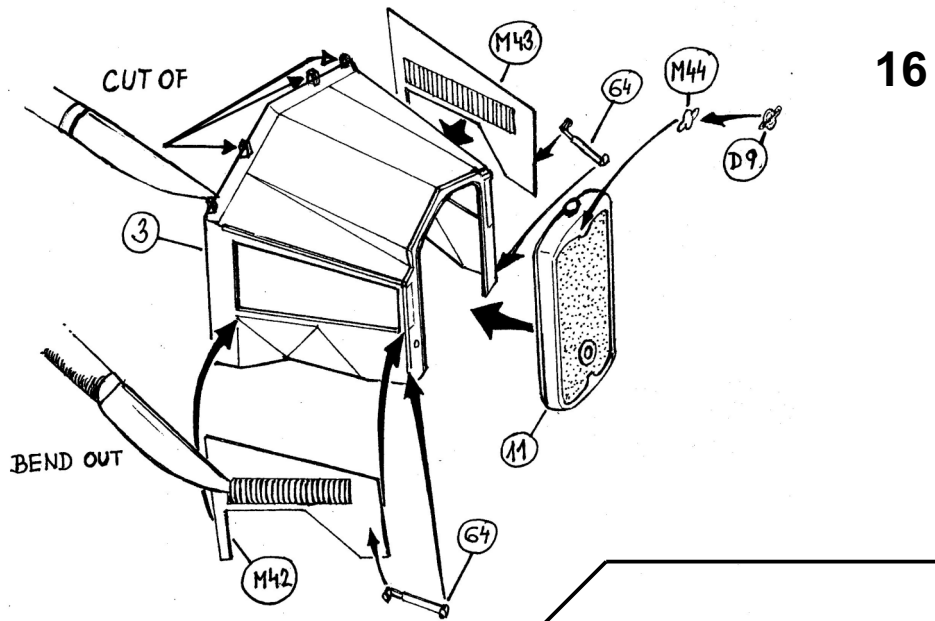

16

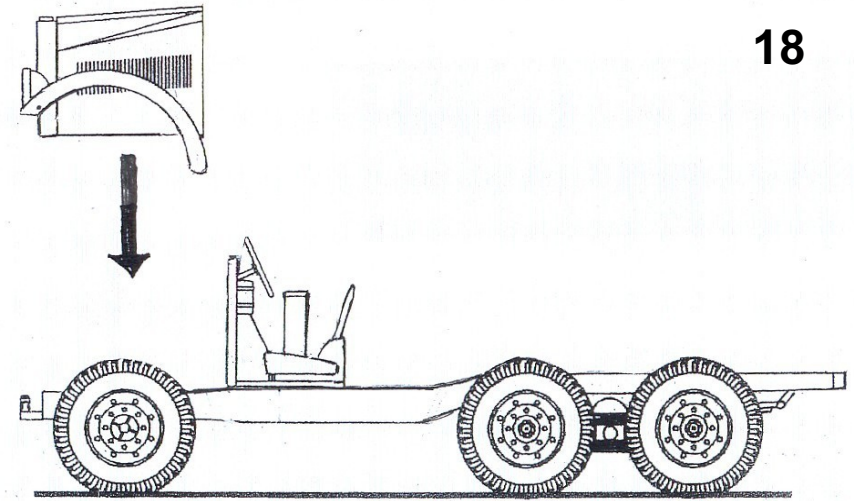

18

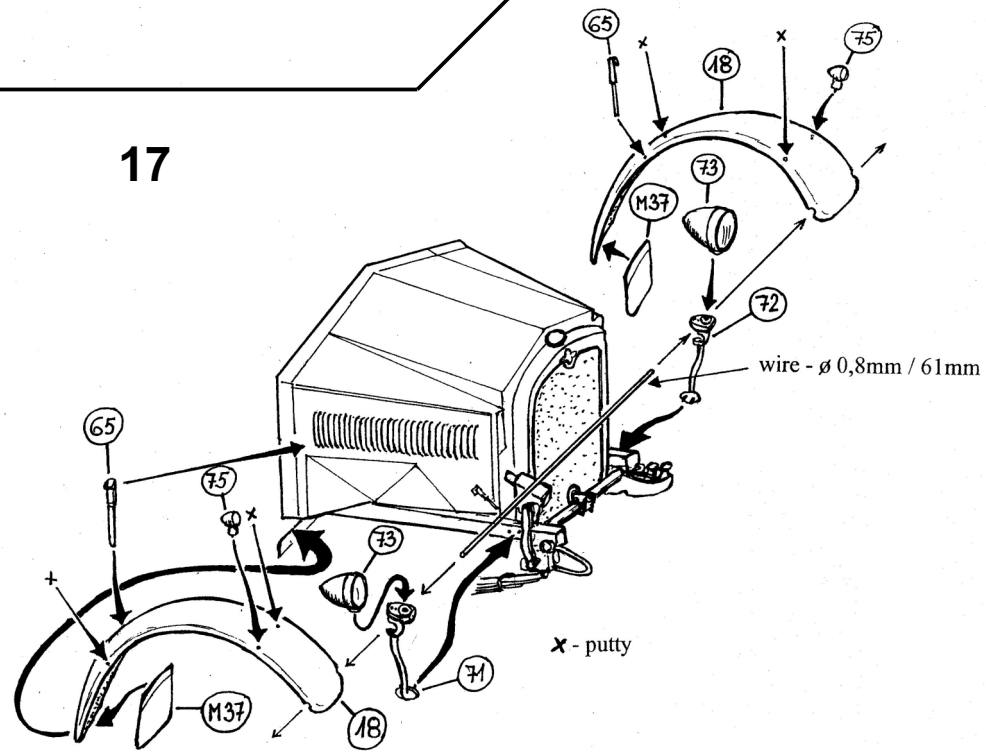

17

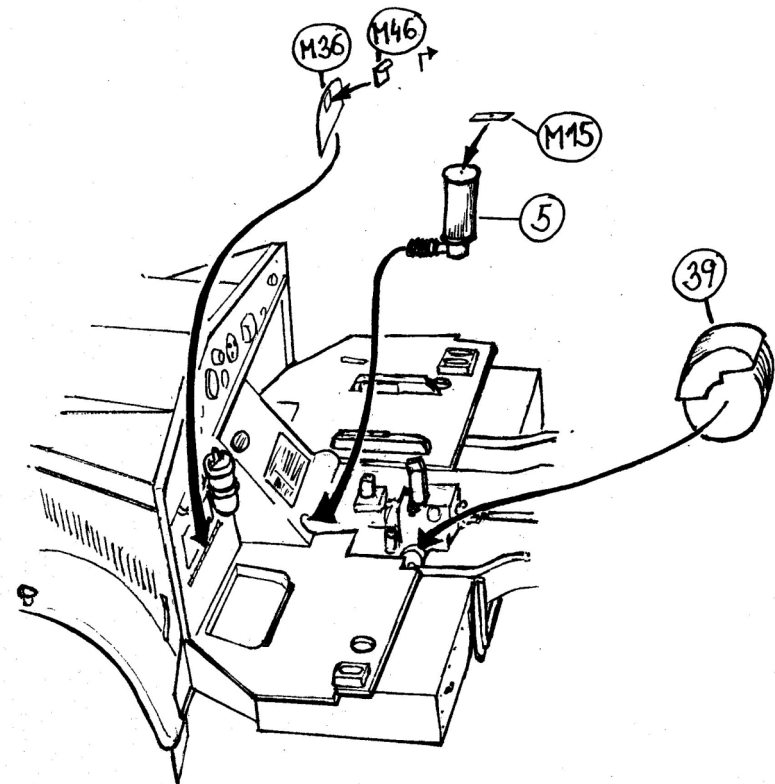

19

Decal schemas

Československý lehký protiletadlový pluk 200 – Východní,
 501 protiletadlový plu, Severní Afrika, březen 1943
 200th Czechoslovakian Light Anti-aircraft regiment - East
 501st Anti-aircraft battalion, North Afrika, March 1943

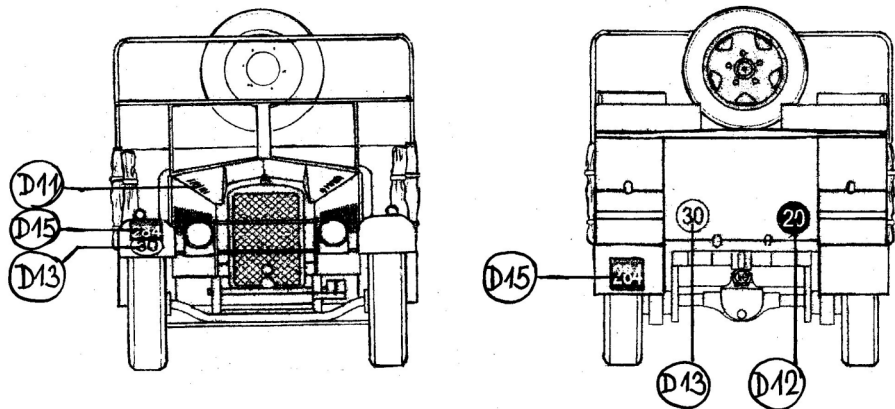

7. Obrněná divize „Desert rats“ , 15.lehký protiletadlový
 prapor, Severní Afrika 1942
 7th Armoured Division „Desert rats“ , 15th Light Anti-aircraft
 regiment, North Africa 1942

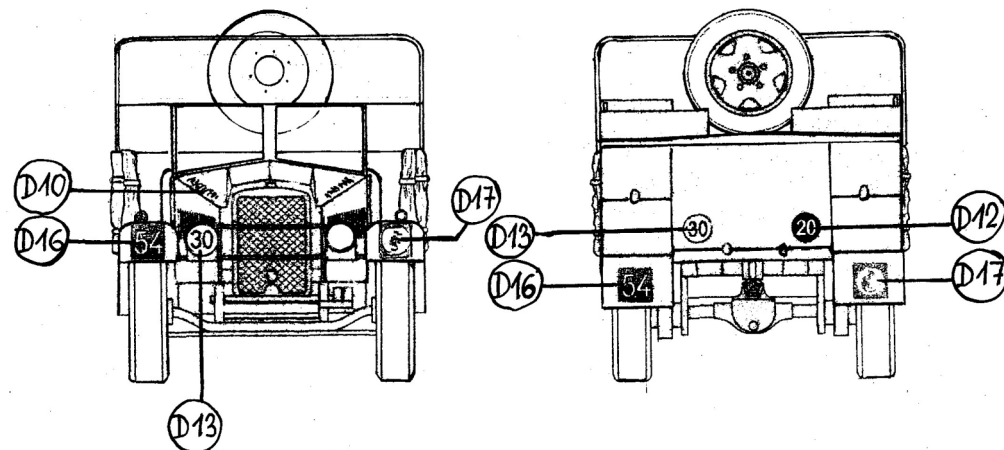

Československý lehký protiletadlový pluk 200 - Východní
 Haifa 1942
 200th Czechoslovakian Light Anti-aircraft Regiment - East
 Haifa 1942

